

Public consultation – Site of former Royal Victoria Hospital

Thank you for requesting the OCPM’s postal kit. Whether you are a resident or a neighborhood visitor, we want to know your opinion.

Content of the postal kit:

- Consultation’s leaflet
- *Document synthèse – Plan directeur d’aménagement – Site du Royal Victoria* from Société québécoise des infrastructures (3.1.1.1) – FRENCH
- *New Vic Project* from McGill (3.2.1.1)
- *Synthèse de l’encadrement règlementaire – Requalification du site de l’Hôpital Royal Victoria* from Ville de Montréal (4.1) - FRENCH
- Questionnaire to write an opinion
- Prepaid return envelope

There are many ways to share your opinion:

- By mail, by filling out and returning us the enclosed questionnaire
- By voice mail, by calling 1 833 215-9314
- Virtually and in person, if the sanitary instructions allow it, by phone or by videoconference during opinion hearing sessions. Book an appointment by calling 514 872-8510.

How to use the postal kit to send your opinion?

1. Read the documents enclosed in the kit.
2. Complete the questionnaire.
3. Return by mail only the completed questionnaire using the prepaid return envelope **before November 21, 2021.**

You have access to the Internet?

All the information regarding the consultation and its virtual process is available on our website at **ocpm.qc.ca/royal-victoria**

Should you have any questions or concerns regarding the project, the available documentation or the different ways to submit your opinion, feel free to contact Gilles Vézina at 514 872-8510.

Consultation

Master Development Plan for the site of the former Royal Victoria Hospital and Allan Memorial Institute

Questions to draw out your opinion

The following questionnaire is part of the hearing-of-opinions process. All comments will be brought to the attention of the commissioners, who will analyze them and write the consultation report as well as the recommendations to be submitted to Montreal elected officials. That is why we ask that you respect OCPM rules and identify yourself so that your opinion is considered. Your comments and name will be published on our Web site. Your other personal information is strictly for the use of the OCPM and will not be made public.

Please write your name here:

Deadline for receiving questionnaires: November 21, 2021

What is the consultation about?

The Quebec Government, via the *Société Québécoise des infrastructures* (SQI), is seeking to repurpose the site of the former Royal Victoria Hospital and Allan Memorial Institute, which has remained mostly vacant since the construction of the Glen Campus of the McGill University Health Centre in 2015. The Master Plan provides for a medium- to long-term vision, as well as guidelines and intervention strategies. The development concept and intervention strategies for the site are presented in the summary of the Master Development Plan (Doc. 3.1.1.1).

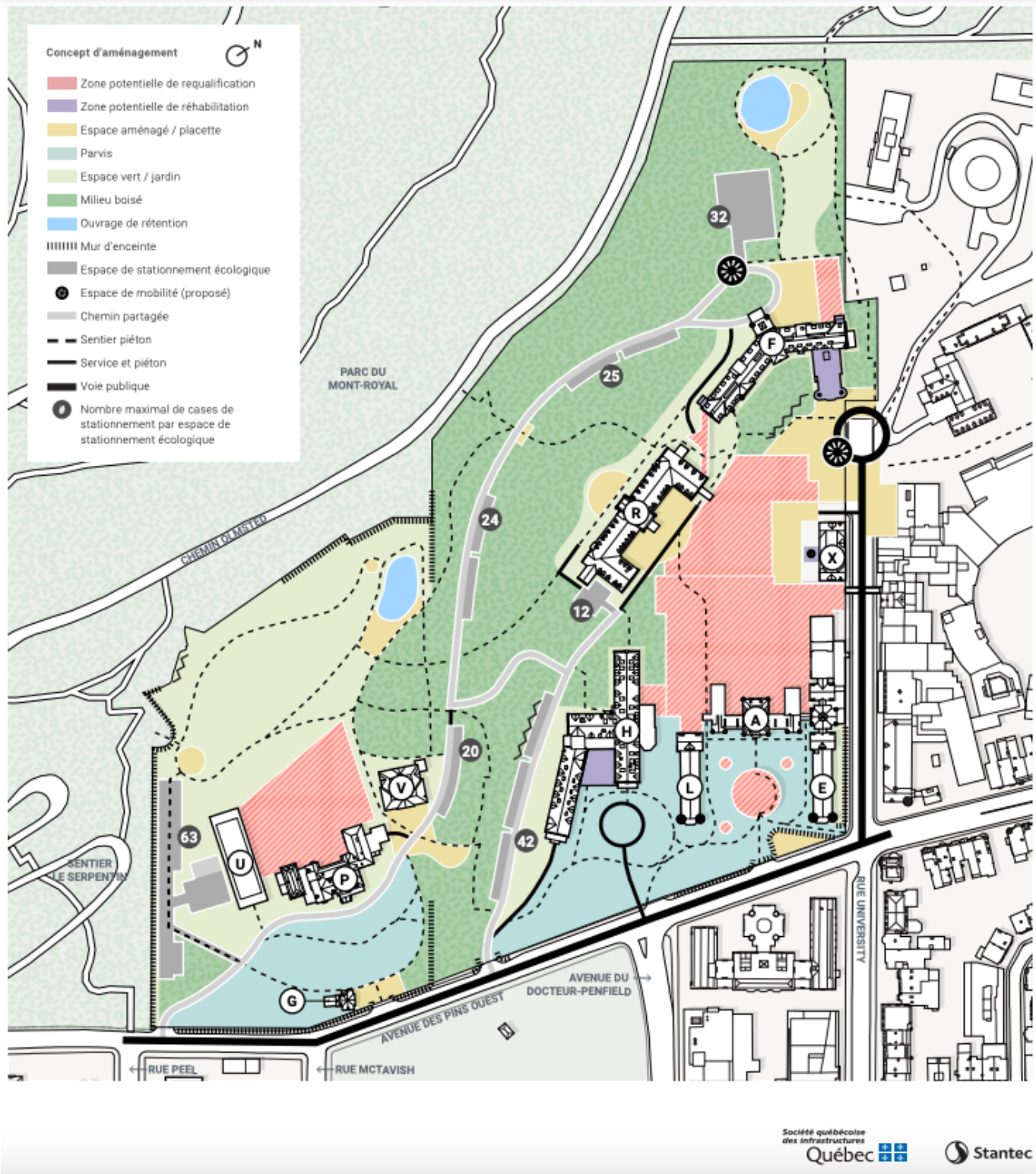

The guidelines and intervention strategies of the Master Development Plan will provide a framework for, among other things, the development of the McGill University project, the New Vic, which is the first concrete project for the site.

Regulatory context

The Mount Royal Protection and Enhancement Plan (MRPEP, 2009) and the Montreal Master Plan call for concerted planning on the part of institutions located within the Mount Royal heritage site. The municipal framework guides the evolution of the properties and heritage enhancement.

In terms of drafting the Master Plan, such concerted planning among the City, the *Société Québécoise des infrastructures (SQI)*, the *ministère de la Culture et des Communications* and McGill University led to the drawing up of two draft by-laws and a development agreement.

The first draft by-law deals with the demolition, construction, transformation and occupation of the buildings, and the development of exterior spaces on the site of the former Royal Victoria Hospital and Allan Memorial Institute. The second draft by-law proposes to amend the land-use designation and several maps (maximum heights, building density, targeted properties, protected natural areas and green spaces) of the Master Plan and its complementary document.



Give your opinion!

The OCPM offers hereunder some open questions to help you to express your opinion on the following subjects:

1. Vocation of the site
2. Architectural, landscape and cultural heritage
3. Sustainable development of the site
4. Governance
5. Mobility
6. Other opinions

The questions provided are optional. You are also invited to give your opinion on any other subjects arising from the proposed changes.



Theme 1: Vocation of the site

The vision put forth by the Société Québécoise des infrastructures (SQI) for the Master Plan of the former Royal Victoria Hospital and Allan Memorial Institute is based on a rehabilitation of the site revolving around the themes of health, knowledge, and well-being. The Plan also aims to promote the appropriation and opening of exterior spaces to the public to make it a destination site.

The first concrete project for the site would be McGill University's. Known as the New Vic, the project targets the development of research focusing on sustainable development in the areas of science, engineering, and public policy. The development project drawn up by the university involves five strategies:

- An inclusive project for Montréal and the university;
- Indigenous recognition;
- Enhancing views of Mount Royal;
- Respecting sustainable development principles;
- Cultural heritage protection.

The project is described in the summary of the conceptual statement of the New Vic project (Doc. 3.2.1.1).



Theme 2: Architectural, landscape and cultural heritage

In its draft Master Development Plan, the Société Québécoise des infrastructures (SQI) recognizes that the site is of high heritage interest, in terms of landscape, social, architectural, and historical aspects. The SQI proposes a repurposing of the site respectful of the heritage value of the existing buildings and layouts, considering their link with the city and the mountain. The objective is to enhance the existing buildings through various modern additions.

The development strategy regarding the built environment and heritage is described on page 11 of the Master Plan summary (Doc. 3.1.1.1).

Bâtiment de conservation et de mise en valeur et Zone potentielle de démolition / déconstruction

- Bâtiment à conserver et à mettre en valeur
- Zone potentielle de démolition / déconstruction (agrandissement de l'existant)
- Zone potentielle de démolition / déconstruction (bâtiment)
- Zone potentielle de démolition / déconstruction (stationnement souterrain et piscine)

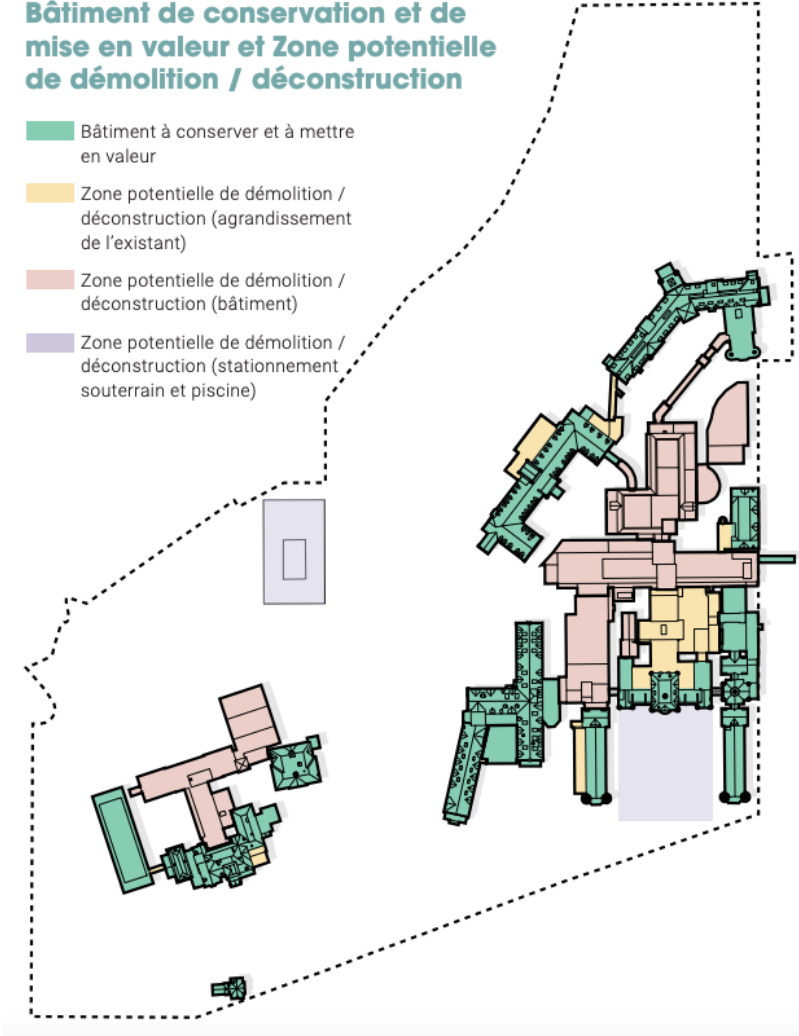

A few questions to guide your thought process

- What do you think of the proposed development strategy concerning heritage?
- In your opinion, what heritage elements of the site of the former Royal Victoria Hospital are the most important and why?

The mobility strategy is described on page 13 and the development concept on page 10 of the Master Development Plan summary (Doc. 3.1.1.1).



A few questions to guide your thought process

- What do you think of the proposals involving the redevelopment and reduction in the number of parking spaces?
- What do you think of the proposals involving the restructuring of internal roads to facilitate public access?
- What do you think of the proposed links between the site and Mount Royal (number, location, etc.)?

